

# RV HARDWARE



2023

[ABSFASSTENERS.COM](http://ABSFASSTENERS.COM)



# RV DRAWER SLIDES & HINGES

## DS35BB - RV SERIES

35 MM PROFILE, 1.2 X 1.2 X 1.2MM THICK

SIZES: 10-28", BULK PACKED

ZINC FINISH

LEVER DISCONNECT

75 LB LOAD CAPACITY

CM - 40PCS/BOX

DM - 80PCS/BOX

**10-12 LB DETENT PULL OUT FORCE**

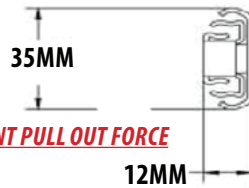

## DS3832A - RV SERIES

46 MM PROFILE, 1.2 X 1.2 X 1.2 MM THICK

SIZES: 10-28", BULK PACKED

ZINC FINISH

LEVER DISCONNECT

100 LB LOAD CAPACITY

CM - 20PCS/BOX

DM - 40PCS/BOX

**10-12 LB DETENT PULL OUT FORCE**

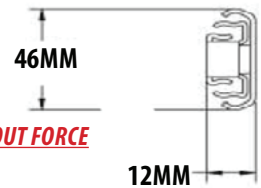

## DS37SCBB - RV SERIES

37 MM PROFILE, 1.2 X 1.2 X 1.2MM THICK

SIZES: 10-28", BULK PACKED

ZINC FINISH

LEVER DISCONNECT

75 LB LOAD CAPACITY

CM - 40PCS/BOX

DM - 80PCS/BOX

**SOFT CLOSE FEATURE DM -**

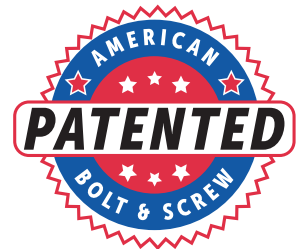
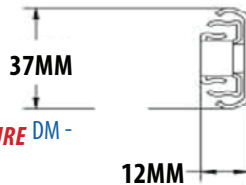

## RV-1

1-WAY LOCKING RV SLIDE

1 POINT OF DETENT

3/4" ALIGNMENT TAB

17-20 LBS DETENT FORCE PER PAIR

**U.S. PATENT PENDING**





# HINGES

## H0012

### FACE MOUNT HINGE

H0012SN - SATIN NICKEL  
H0012ORB - OIL RUBBED BRONZE  
H0012BK - MATTE BLACK  
H0012P - PEWTER \*  
H0012SP - SATIN PEWTER  
H0012NB - BLACK NICKEL  
H0012B - POLISHED BRASS  
H0012WH - WHITE  
H0012WEN - WEATHERED ENGLISH NICKEL



## H5003

### FACE MOUNT SELF-CLOSING HINGE

H5003SN - SATIN NICKEL  
H5003ORB - OIL RUBBED BRONZE  
H5003BB - BURNISHED BRASS \*  
H5003BK - MATTE BLACK  
H5003WH - WHITE  
H5003B - POLISHED BRASS  
H5003SP - SATIN PEWTER  
H5003PC - POLISHED CHROME



## H50038

### FACE MOUNT, SELF-CLOSING HINGE 3/8" INSET

H50038SN - SATIN NICKEL \*  
H50038ORB - OIL RUBBED BRONZE  
H50038AB - ANTIQUE BRASS  
H50038BK - MATTE BLACK  
H50038B - POLISHED BRASS  
H50038PC - POLISHED CHROME  
H50038BB - BURNISHED BRASS  
H50038WH - WHITE



## H0013

### NON MORTISE 3-LEAF HINGE

H0013SN - SATIN NICKEL  
H0013ORB - OIL RUBBED BRONZE  
H0013BK - MATTE BLACK \*  
H0013AB - ANTIQUE BRASS  
H0013WH - WHITE  
H0013NB - BLACK NICKEL  
H0013AL - ALMOND  
H0013B - POLISHED BRASS



## H0014

### NON MORTISE 3-LEAF EXTENDED HINGE

H0014SN - SATIN NICKEL  
H0014B - BRASS \*



EXTENDED LEAF

## H0035

### NON MORTISE BUTTERFLY HINGE

H00350SN - SATIN NICKEL  
H0035ORB - OIL RUBBED  
BRONZE \*



# CONCEALED HINGES

## HC5B15N/30B10

### COMPACT CONCEALED HINGE

1/2" PARTIAL WRAP STEEL PLATE W/ DOWELS  
NICKEL PLATED  
ALSO AVAILABLE WITHOUT DOWELS & 3/8" OVERLAY



## HSE60444N

### COMPACT CONCEALED HINGE

1/2" FULL WRAP STEEL PLATE W/ DOWELS  
NICKEL PLATED, SOFT CLOSE AVAILABLE  
ALSO AVAILABLE WITHOUT DOWELS & 3/4" FRAME



## HC294

### 1 PIECE, 2-CAM CONCEALED FACE FRAME HINGE, 1/2" OVERLAY

NICKEL PLATED  
ALSO AVAILABLE WITH DOWELS



## HC707142

### 1 PIECE CONCEALED FACE FRAME HINGE, 1/2" OVERLAY

NICKEL PLATED  
ALSO AVAILABLE WITH DOWELS



HC295 7/16" OVERLAY  
HC295-D 7/16" W/ DOWELS  
HC296 3/4" OVERLAY  
HC296-D 3/4" W/ DOWELS  
HC297 1" OVERLAY  
HC297-D 1" W/ DOWELS

HC298 1-1/4" OVERLAY  
HC298-D 1-1/4" W/ DOWELS  
HC299 1-3/8" OVERLAY  
HC299-D 1-3/8" W/ DOWELS  
HC300 1-1/2" OVERLAY  
HC300-D 1-1/2" W/ DOWELS

HC70758 5/8" OVERLAY  
HC70758-D 5/8" W/ DOWELS  
HC70734 3/4" OVERLAY  
HC70734-D 3/4" W/ DOWELS  
HC707114 1-1/4" OVERLAY

HC707114-D 1-1/4" W/ DOWELS  
HC707138 1-3/8" OVERLAY  
HC707138-D 1-3/8" W/ DOWELS  
HC70716 1-7/16" OVERLAY  
HC70716-D 1-7/16" W/ DOWELS



## HC280SC

### 1 PIECE, 1/2" OVERLAY CONCEALED HINGE 6-WAY ADJUSTABLE SOFT CLOSE WITH DOWELS

AVAILABLE IN NICKEL PLATES

## HC5B15N/30B10-RV-1

### COMPACT CONCEALED HINGE 1/2" OVERLAY PARTIAL WRAP STEEL PLATE/W DOWELS RV- DETENT FEATURE.

AVAILABLE IN NICKEL PLATES

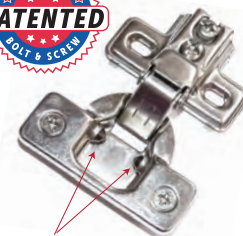



# BATH HARDWARE



\* PICTURED IN POLISHED CHROME

AVAILABLE IN  
OIL RUBBED BRONZE  
MATTE BLACK SATIN  
NICKEL

**BH9129W**  
PAPER ROLLER 5/8"  
SINGLE TIP PLASTIC WHITE



**RH430SN**  
ROBE HOOK  
POLISHED CHROME  
ALSO AVAILABLE IN OIL RUBBED BRONZE



**BH1931PC**  
TOILET PAPER HOLDER  
POLISHED CHROME  
ALSO AVAILABLE IN SATIN NICKEL  
& OIL RUBBED BRONZE



**BH16374SN**  
TOWEL RING  
POLISHED CHROME  
ALSO AVAILABLE IN SATIN NICKEL  
& OIL RUBBED BRONZE



**BH9229BSN**  
TOOTHBRUSH & CUP HOLDER  
SATIN NICKEL  
ALSO AVAILABLE IN OIL RUBBED BRONZE



**BH99319BSN**  
SOAP DISH HOLDER  
SATIN NICKEL  
ALSO AVAILABLE IN OIL RUBBED BRONZE



**BH11037PC**  
18" TOWEL BAR  
POLISHED CHROME  
ALSO AVAILABLE IN SATIN NICKEL

**BH11037PC**  
24" TOWEL BAR  
POLISHED CHROME  
ALSO AVAILABLE IN SATIN NICKEL

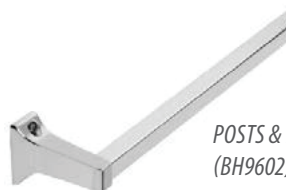

POSTS & BAR ALSO SOLD SEPARATELY  
(BH9602) (BH9607-BH9608)





# INTERIOR LOCKS

## LSML-C4

### TULIP STYLE PASSAGE LOCKSET

#### 7/8" METAL LATCH AND STRIKE PLATE

LSML-C4-US15 - SATIN NICKEL

LSML-C4-ORB - OIL RUBBED BRONZE

LSML-C4-US3 - POLISHED BRASS

LSML-C4-WEN - WEATHERED ENGLISH NICKEL \*

LSML-C4-BK - MATTE BLACK



## LSML-C5

### TULIP STYLE PRIVACY LOCKSET

#### 7/8" METAL LATCH AND STRIKE PLATE

LSML-C5-US15 - SATIN NICKEL \*

LSML-C5-ORB - OIL RUBBED BRONZE

LSML-C5-US3 - POLISHED BRASS

LSML-C5-BK - MATTE BLACK



## LSML-RT4 **NEW!**

### REDUCED TULIP PASSAGE LOCKSET

#### 7/8" METAL LATCH, SMALL STRIKE

LSML-RT4-US15-RV-LOCK



## LSML-RT5 **NEW!**

### REDUCED TULIP PRIVACY LOCKSET

#### 7/8" METAL LATCH, SMALL STRIKE

LSML-RT5-US15-RV-LOCK

# BENT LEVER

## LSML-BL4

### BENT LEVER PASSAGE LOCKSET

#### 7/8" LATCH, SMALL STRIKE

LSML-BL4-US15-RV-LOCK

## LSML-BL5

### BENT LEVER PRIVACY LOCKSET

#### 7/8" METAL LATCH, SMALL STRIKE

LSML-BL5-US15-RV-LOCK



# STRAIGHT LEVER

## LSML-L4

### LEVER STYLE PASSAGE LOCKSET

#### 7/8" METAL LATCH AND STRIKE PLATE

LSML-L4-US15 - SATIN NICKEL

LSML-L4-ORB - OIL RUBBED BRONZE

LSML-L4-US3 - POLISHED BRASS

LSML-L4-NB - BLACK NICKEL \*



## LSML-L5

### LEVER STYLE PRIVACY LOCKSET

#### 7/8" METAL LATCH AND STRIKE PLATE

LSML-L5-US15 - SATIN NICKEL \*

LSML-L5-ORB - OIL RUBBED BRONZE

LSML-L5-US3 - POLISHED BRASS



# ROUND BALL

## LS-RB4

### ADDISON BALL STYLE PASSAGE LOCK

#### FOR DOORS 1 3/8 - 1 3/4" T

LS-AD4-US15 - SATIN NICKEL \*

LS-AD4-ORB - OIL RUBBED BRONZE



## LS-RB5

### ADDISON BALL STYLE PRIVACY LOCKSET

#### FOR DOORS 1 3/8 - 1 3/4" THICK

LS-AD6-US15 - SATIN NICKEL

LS-AD5-ORB - OIL RUBBED BRONZE \*





# EXTERIOR HARDWARE

## **GHRV-10CHROME**

**10" RV GRAB HANDLE**  
POLISHED CHROME



## **GHRV-9BK**

**9" RV GRAB HANDLE**  
CONCEALED SCREW  
BLACK PLASTIC



## **GHRV-9W**

**9" RV GRAB HANDLE**  
CONCEALED SCREW  
WHITE PLASTIC



## **GHRV-9BKE**

**9" RV GRAB HANDLE, EXPOSED SCREW**  
AVAILABLE IN BLACK OR WHITE PLASTIC



## **DHB-BKP-6**

**6" T-STYLE DOOR HOLD BACK**  
BLACK OR WHITE PLASTIC WITHOUT BUMPER  
ALSO AVAILABLE IN 3-1/2"



## **RV EXHAUST HANGER**

AVAILABLE IN 7-1/2" & 10-1/2"



## **45° T-STYLE DOOR HOLDER**

**GREAT FOR GETTING AROUND OBSTACLES**  
ALSO AVAILABLE IN STAINLESS STEEL



## **90° T-STYLE DOOR HOLDER**

**4", STAINLESS STEEL**  
GREAT FOR GETTING AROUND OBSTACLES  
ALSO AVAILABLE IN STEEL ZINC



## **6-LEAF SCREEN DOOR HINGE**

**ALUMINUM, BLACK OR WHITE POWDER COATED**  
ALSO AVAILABLE IN FRICTION STYLE HINGE  
AND 5-LEAF (NO SCREEN DOOR)



## **BAGGAGE DOOR MAGNETS**

**HIGH STRENGTH, MALE & FEMALE SETS**  
AVAILABLE IN BLACK OR WHITE





# INTERIOR HARDWARE

## CL150SN

### RV CANDY CANE LATCH

1-1/2", SATIN NICKEL OR OIL RUBBED BRONZE



## MS100AB

### 6" RV MINI STRUT

ABS ANTIQUE BLACK OR SATN NICKEL FINISH



## CAMPER DOOR LATCH

### KEYED ALIKE, UNIVERSAL DOOR LATCH

PAINTED DIE CAST STEEL

AVAILABLE IN BLACK OR WHITE



## D9006

### 3" DOOR STOP

#### FLOOR MOUNT

D9006SN - SATIN NICKEL \*

D9006ORB - OIL RUBBED BRONZE



## SB66902

### 8" FOLDING SHELF BRACKET

ALSO AVAILABLE IN 12"



SB66902SW - WHITE

SB66902SBR - BROWN \*

SB66902SBK - BLACK

## DB-12WHITE

### DRAPERY HOLDBACK BRACKET

PLASTIC WHITE



## DB-12ZN

### DRAPERY HOLDBACK BRACKET

CLOSED END, ZINC FINISH



## WA-ADJ-SH90BK

### 90" BLACK WEBBING ASSEMBLY

ADJUSTABLE W/SNAP HOOKS ON EACH END



## BL1200SN-SPEC

### BUNK LATCH, FLAT & UNIVERSAL STRIKES

SATIN NICKEL OR OIL RUBBED BRONZE FINISH



## SA18

### 18" POLY ADJUSTABLE SHELF

#### STANDARD SPEED STRIP

ALSO AVAILABLE IN 24"



SA18W - WHITE

SA18BR - BROWN

SA18DBR - DARK BROWN

## C412

### DOUBLE ROLLER CATCH

#### 10-12 LBS DETENT FORCE

C412AC - ANTIQUE COPPER

C412Z - ZINC \*



## C411

### DOUBLE ROLLER CATCH

#### 7-8 LBS DETENT FORCE

C411AC - ANTIQUE COPPER \*

C411Z - ZINC



## NEODYMIUM RING

## MAGNETS & STEEL CUPS

### POWERFUL MAGNETISM

OD SIZES: .375 THRU 1"

AVAILABLE IN GRADES 35 - 42



## C907

### SINGLE MAGNETIC TOUCH

#### LATCH WITH STRIKE

C907BK - BLACK \*

C907BR - BROWN

C907W - WHITE



## C927

### DOUBLE MAGNETIC CATCH

#### WITH STRIKES

C927BK - BLACK

C927BR - BROWN \*

C927W - WHITE



## C713

### SINGLE MAGNETIC CATCH WITH STRIKE

#### PLATE, 10LBS PULL FORCE

C713BR - BROWN

C713BK - BLACK

C713W - WHITE \*





# GAS STRUTS

## GAS SPRINGS

**CUSTOM SIZES & RATINGS AVAILABLE**  
INCLUDES A BLACK POWDER COATED TUBE  
BLACK NITRIDED CORROSION RESISTANT ROD  
SURFACE AND SOCKET STYLE END FITTINGS



## BALL STUDS

**2 PER PACK**  
10 MM



## MOUNTING BRACKETS

**2 PER PACK**  
10 MM



## ANGLED MOUNTING BRACKETS

**SEVERAL STYLE OPTIONS, 2 PER PACK**  
10 MM



## FLAT MOUNTING BRACKETS

**SEVERAL STYLE OPTIONS, 2 PER PACK**  
10 MM



## RIGHT CURVED BRACKET

**HIGH QUALITY STEEL AND RUST RESISTANT**  
10 MM BALL MOUNT, 1" ON CENTER MOUNTING HOLES



## LEFT CURVED BRACKET

**HIGH QUALITY STEEL AND RUST RESISTANT**  
10 MM BALL MOUNT, 1" ON CENTER MOUNTING HOLES



## TECHNICAL INFORMATION

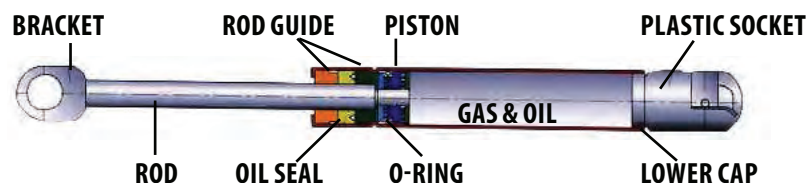

### GAS SPRING DEFINITIONS:

- A – EXTENDED LENGTH (INCHES)
- B – STROKE (INCHES)
- C – COMPRESSED LENGTH (INCHES)
- D – ROD DIAMETER (MM)
- E – TUBE DIAMETER (MM)
- P1 = FORCE IN POUNDS AT FULL EXTENSION

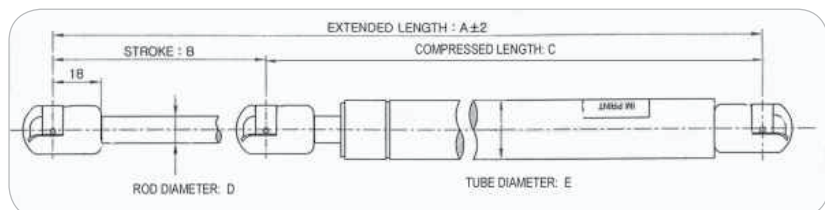

## ACCESSORY & MOUNTING HARDWARE

**FOR COMMONLY USED CAMPER SHELL OEM'S**  
CAMS, DEADBOLTS, ROD GUIDES, CAM LOCKS  
FITTINGS, BRACKETS AND MORE

## ANGLED END FITTING

**2 PER PACK**  
M6 THREAD, 10MM BALL



## SNAP-ON ND FITTINGS

**2 PER PACK**  
M6 THREAD, 10MM BALL



## END FITTING

**2 PER PACK**  
M6 THREAD, 10MM BALL



## CLEVIS END FITTING

**2 PER PACK**  
M8 X .374", OR M6 X .374 THREAD SIZE



## EYELET END FITTING

**2 PER PACK**  
M6 X .388" THREAD SIZE



## STEEL SPRING END FITTINGS

**2 PER PACK**  
M6 THREAD, 10MM BALL

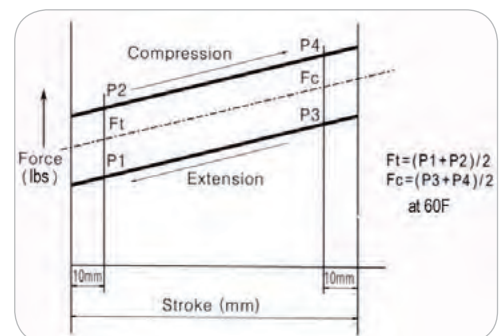





# JOHNSON HARDWARE



MADE IN THE USA

## POCKET DOOR HARDWARE

DOOR FRAMES - HARDWARE SETS - LOCKS AND PULLS  
DOOR JAMB KITS - ACCESSORIES



## WALL MOUNT (BARN DOOR) HARDWARE

TOP MOUNT - SIDE MOUNT - SEVERAL RAIL OPTIONS  
COMMERCIAL GRADE - AVAILABLE IN SOFT CLOSE



## SLIDING BYPASS HARDWARE

TOP MOUNT - SIDE MOUNT - SEVERAL RAIL OPTIONS  
RESIDENTIAL OR COMMERCIAL GRADE - AVAILABLE IN SOFT CLOSE



## BI-FOLDING DOOR HARDWARE

TOP MOUNT - SIDE MOUNT - TAP IN - FULL ACCESS  
RESIDENTIAL OR COMMERCIAL GRADE



## MULTI-FOLDING HARDWARE

TOP MOUNT - INTERIOR SHUTTER HARDWARE  
RESIDENTIAL OR COMMERCIAL GRADE



## PARTS & ACCESSORIES

DOOR HANGERS - TRACK - PULLS - KNOBS - GUIDES  
TRACK STOPS - DOOR STOPS - HINGES - PIVOTS - ETC.

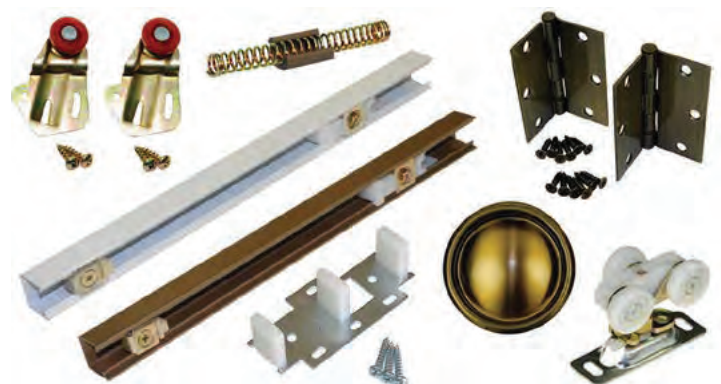



# RV-1 SLIDER

## NEW & PATENTED!

U.S. PATENT NO. 10,206,504

The NEW RV-1 Locking Slide is designed and intended to be used in the assembly of drawers specifically for the RV industry.

A highly durable plastic stop was added to the top of each slide which acts as a lock and stop when the drawer and cabinet mate during assembly.



Avoid the cost and labor of annoying roller catches.  
The ABS RV-1 Slide incorporates the Detent feature ALL-IN-ONE!

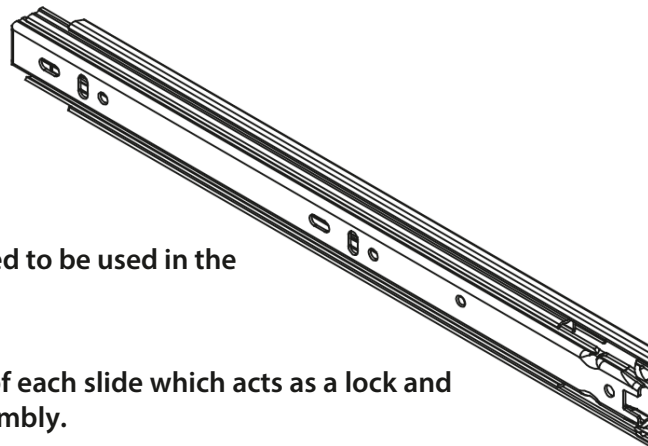

## RV-1 LOCKING SLIDE FEATURES

- 35MM PROFILE
- MADE FROM 1.2MM THICK STEEL
- ONE POINT OF DETENT
- 17-20 LBS OF DETENT FORCE PER PAIR
- UP TO 75 LBS OF LOAD CAPACITY PER PAIR
- 50,000 CYCLES TESTED AND APPROVED
- SELF-ALIGNING TAB TO FIT UP TO 3/4" FACE FRAMES

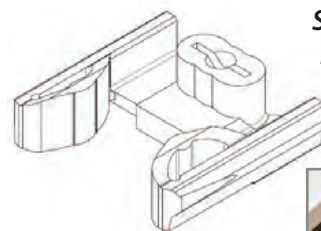

Stop feature is built right into the slide!



## RV-1 VS. THE COMPETITION

	ABS RV-1 SLIDE	COMPETITION'S SLIDE
Material Thickness .....	1.2MM .....	1.0MM
Detent Force .....	17-20 LBS .....	9-10 LBS

**THE RV-1 LOCKING SLIDE IS ONLY AVAILABLE AT ABS!**

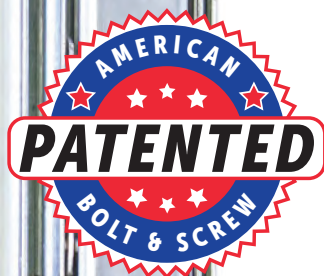





# RV-CONCEALED HINGES

**U.S. PATENT PENDING**

The NEW RV-Concealed Hinge is designed and intended to be used in the assembly of cabinets specifically for the RV industry.

A highly durable Detent Ball was added to the cup of the hinge which acts as a detent force when the cabinet is in the closed position, thus allowing the cabinet to stay shut while in transit.



*Avoid the cost and labor of annoying roller catches.  
The ABS RV-Concealed Hinge incorporates the Detent feature ALL-IN-ONE!*

## RV-CONCEALED HINGE FEATURES

- 35MM CUP
- 6-WAY ADJUSTABLE COMPACT DESIGN
- 105 DEGREE OPENING
- 12-15 LBS OF DETENT FORCE
- ADJUSTABLE DETENT OPTION



**Detent Balls**  
*Help keep cabinet shut while in transit*

**THE RV-CONCEALED HINGE IS  
ONLY AVAILABLE AT ABS!**



# SLIDE OUT ROLLERS

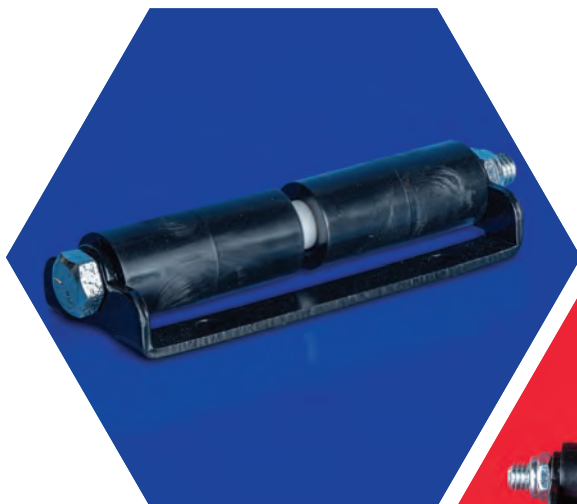

/SSR462BK/P1086 SLIDEOUT SUPPORT ROLLER  
4-5/8" X 1-49/64" STEEL/DELRIN (ROLLERS)  
BLACK POWDER COAT

## GENERAL DATA

BASE LENGTH: 4-5/8"

HEIGHT OVERALL: 1-3/32"

MOUNTING HOLE DIAMETER: 1/4"

BASE WIDTH: 1-3/4"

ROLLER LENGTH: 4-5/32"

MOUNTING HOLE QTY: 4

## Special Requests

DOUBLE ROLLER FOR SMOOTH OPERATION

## PHYSICAL REQUIREMENTS

BASE MATERIAL: STEEL

ROLLER MATERIAL: DELRIN

BASE FINISH: BLACK POWDERCOAT

ROLLER FINISH: BLACK





# RV RAMP DOOR HARDWARE

***YOUR PREMIERE SOURCE FOR RAMP DOOR HARDWARE***



**BAR LOCKS**



**RAMP DOOR  
CABLES**



**BUMPERS**



**ALUMINUM HINGE  
LEAFS & CAPS**



**LOCKING HASPS**



**TIE DOWNS**



**RAMP DOOR  
TORSION SPRING**

## ***BENEFITS WITH ABS***

- High Quality Sourced Parts
- Tested & Proven in the Market
- Inventory Ready to Ship

***For more information contact your ABS sales rep today!***



# TRAVEL TRAILER LOCKS



## **ENTRY DOOR LOCK FEATURES**

- Glass Filled Nylon Design-UV Resistant
- Keyed Cylinder & Deadbolt
- Available in Black, White & Chrome
- Available in Custom Keyways
- Tested to 200,000 cycles.
- Strike Plates & mounting hardware included.



Available in Black, White & Chrome

## **BAR LOCK HASPS FEATURES**

- Zinc Alloy Design
- Keyed Cylinder
- Squared or Modern Design available
- Mounting hardware included
- Custom Keyways available (Keyed alike program)



Squared or Modern Design available





# QUICK REFERENCE

*A quick, visual reference of common fasteners.*

## BOLTS



Hex Cap Screw



Hex Tap Bolt



Hex Machine Bolt



Carriage Bolt



Hex Lag Bolt



Flange Bolt



Elevator Bolt



U-Bolt



Hanger Bolt



Eye Bolt



Track Bolt



Joint Connector Bolt

## SOCKETS



Socket Head Cap Screw



Flat Head Socket Cap Screw



Button Head Socket Cap Screw



Socket Head Shoulder Screw



Socket Set Screw



Hex Key

## NUTS



Finished Hex Nut



Finished Hex Jam Nut



Machine Screw Nut



Square Machine Screw Nut



Coupling Nut



Flange Nut



Acorn Nut



Nylon Insert Lock Nut



Keps Lock Nut



Slotted Nut



Square Nut



Wing Nut



Tee Nut



Propell Nut



Joint Connector Nut



Weld Nut



Cross Dowell Nut



Flat Retainer Nut



Insert Nut

## WASHERS

USS Flat Washer



SAE Flat Washer

Fender Washer



Bonded Sealing Washer

Medium Split Flat Washer



Finishing Washers

Internal Tooth Lockwasher



External Tooth Lockwasher

Internal/External Tooth Lockwasher



Torque Washer

## PINS



Dowel Pin



Roll Pin



Hitch Pin Clip



Clevis Pin



Bed Pin



Bullet Pin



Racking Pin

## SCREWS



Machine Screw



Sheet Metal Screw



Self Drilling Screw



Thread Cutting Screw



Wood Screw



Drywall Screw



Thumb Screw



Dowel Screw

## RIVETS



Blind Rivets - Aluminum, Steel & Stainless Steel



Large Flange



Semi-Tubular

## NAILS



Box Nails



Common Nails



Drive Screw Nails



Roofing Nails



Duplex Nails



Joist Hanger Nails



Masonry Nails



Ring Shank Nails



Drywall Nails

*Many plating, coating, and finish options are available on most products. Just let us know your requirements!*





# HEADS, THREADS, DRIVES

## HEAD STYLES



## RECESS STYLES



## THREAD TYPES

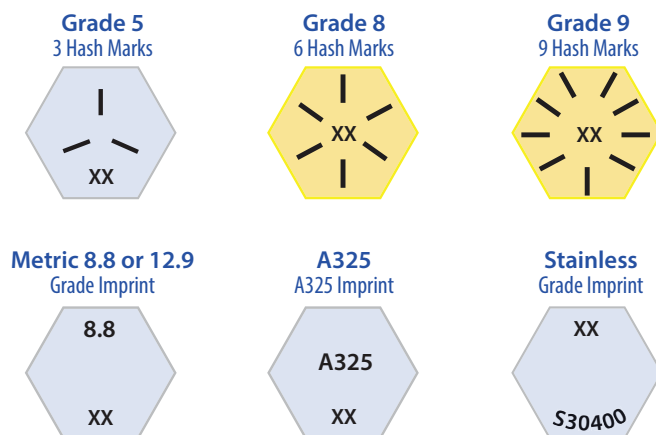
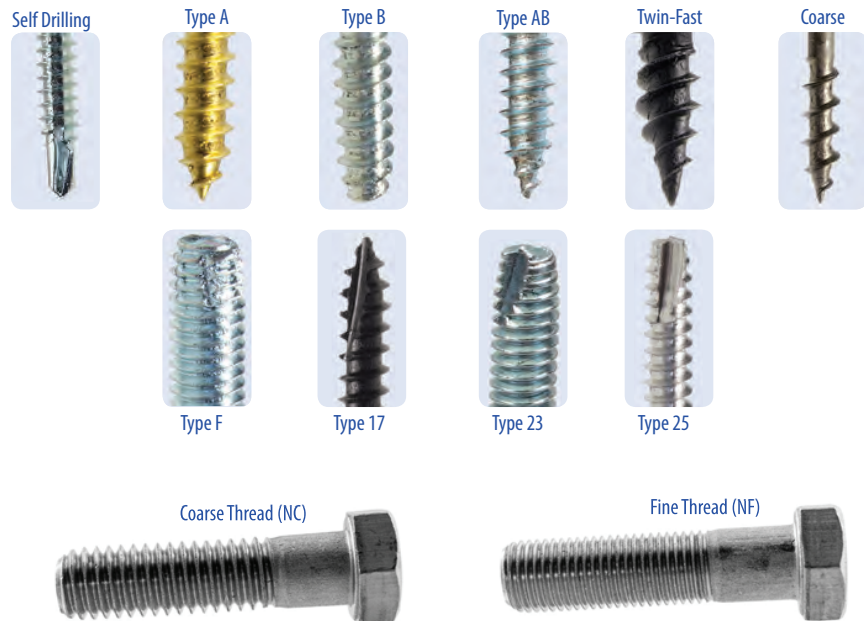

## BOLT HEAD IDENTIFICATION

The markings on the head of a bolt can help ID it's grade and man-ufacturer. The grade is usually represented by hashmarks or a number. Manufacturer ID's are usually initials or a custom logo designated for their use only.





# PAINTING SERVICES

## FASTENER PAINTING

- Can run many sizes and colors at the same time
- Diameters: #4 thru 3/8
- Lengths: Up to 3"
- Add Neoprene or detachable washers
- Powder Coating
- ISO:9000 Compatible
- Screws, Blind Rivets, Nuts, Washers
- Must be clean - free of oil or wax
- Pantone Colors - Anything under the rainbow
- Any Finish - From high gloss to flat
- Metallic and UV resistant also available
- Polyurethane or Waterborne



## BENEFITS OF PAINTING...

- Painting offers a seamless look to your project, helping the fastener blend in to the surrounding surface.
- It also offers corrosion and rust resistance, so your fastener will last longer when exposed to the elements.

## TYPES OF FASTENERS

- Screws
- Bolts
- Washers
- Rivets
- Nails

## COMMON APPLICATIONS

- Rain Gutters
- Metal Roofing
- Electrical Projects
- Decking
- Carpentry
- Truck & Trailer
- Vinyl Fencing

**ANY COLOR...  
ANY FINISH!**

*Need a custom color for a job? DONE!*





# PLATING REFERENCE

## NICKEL ELECTROPLATE

- Decorative silver appearance
- Good wear
- Mild corrosion resistance - for indoor use



## ZINC ELECTROPLATE

- Bright blue or white appearance
- Moderate corrosion resistance - for suburban use

## ZINC MECHANICAL PLATE

- Similar in appearance to electroplate
- Less susceptible to hydrogen embrittlement
- Moderate corrosion resistance - for suburban use



## ZINC ELECTROPLATE - YELLOW CHROMATE

- Thicker conversion than clear
- Severe corrosion resistance - for industrial use



## ZINC ELECTROPLATE - OLIVE DRAB CHROMATE

- Thicker coating than yellow
- Severe corrosion resistance - for industrial use

## ZINC MECHANICAL - BRIGHT CHROMATE

- Thin bright conversion coating
- Can be dyed for paint bonding
- Moderate corrosion resistance - for suburban use

## ZINC MECHANICAL - YELLOW CHROMATE

- Thicker conversion than clear
- Increased corrosion resistance - for industrial use

## ZINC MECHANICAL - OLIVE DRAB CHROMATE

- Thicker coating than clear
- Increased corrosion resistance - for industrial use

## ZINC MECHANICAL - CHROMATE + ORGANIC

- Additional organic (cured) coating
- Increased corrosion resistance - for industrial use

## BLACK OXIDE + OIL

- Porous & thin
- Mild corrosion resistance - for indoor use



## BRASS PLATE - LACQUERED

- Decorative electroplated finish
- Mild corrosion resistance - for indoor use

## CHROMIUM ELECTROPLATE

- Bright lustrous blue / white finish
- Mild corrosion resistance - for indoor use

## AL-1000 COATING

- Recommended on parts where stress and corrosion are a problem
- Uniform decorative finish
- No hydrogen embrittlement
- Excellent solvent & corrosion resistance
- Hard, durable coating will take abuse without chipping or scratching Can be applied to Carbon Steel, Alloy Steel, Stainless Steel, Titanium, and Aluminum Alloys.

## JS-1000 COATING

- Proven to remain 100% rust free in over 1000 hours of salt spray testing
- High lubricity for reduced tapping torque
- Hexavalent Chromium Free and RoHS compliant
- Completely non-toxic & environmentally friendly
- Can be powder coated for color match which also increases rust resistance



## AL-2000 COATING

- No electrochemical or chemical atmosphere corrosion
- Excellent corrosion and solvent resistance
- Uniform decorative finish in black, silver & gold
- Absolutely no hydrogen embrittlement



## COPPER ELECTROPLATE - LACQUERED

- Bright decorative finish
- Electrically Conductive
- Mild corrosion resistance - for indoor use

## CHROMIUM ELECTROPLATE - COPPER & NICKEL UNDERCOAT

- Surface is hard and abrasive resistant
- Primarily for decorative use
- Mild corrosion resistance - for indoor use

## HOT DIP ZINC MECHANICAL GALVANIZED

- Dark grey, very thick coating
- Severe corrosion resistance - for industrial use

## WHAT IS...

### Conversion Coating

A chemical reaction converts part of the metal surface into the coating.

### Hydrogen Embrittlement

The accidental introduction of hydrogen into the metal reduces tensile strength of material which could lead to fractures or cracks in the fastener.

### RoHS Compliant

Stands for: Restrictions of Hazardous Substances. It restricts use of 10 hazardous materials found in electrical and electronic products.

**ABS**FASTENERS.COM

**CALIFORNIA (HQ)**  
800-325-0844

**OREGON**  
800-392-8752

**ARIZONA**  
800-337-9008

**TEXAS**  
800-316-9899

**GEORGIA**  
800-819-8944

**INDIANA**  
800-322-4050

**MEXICO**  
664-625-4671